

ABOVE DOOR DOME PANELS

Interior Above Door Dome Panels are exactly what you're looking for to customize your rigs interior! Designed and crafted from 304 Corrosion Resistant #8 Non-Directional Stainless Steel, the Iowa Customs Door Dome Panels install in your existing truck dome mounting holes, so no drilling is required. Additionally, there are multiple light hole configurations!

304 CORROSION RESISTANT
304 Stainless Steel | Rust Free | Weather Proof



KENWORTH
FITMENT
GUIDE

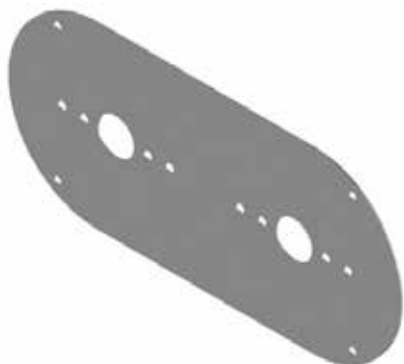

IC966020-14

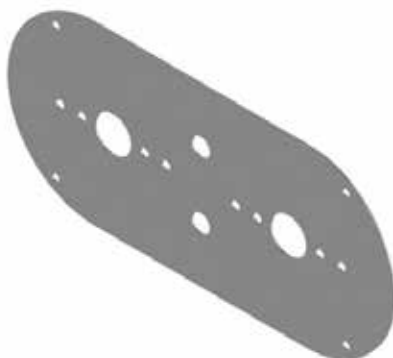

IC966021-14

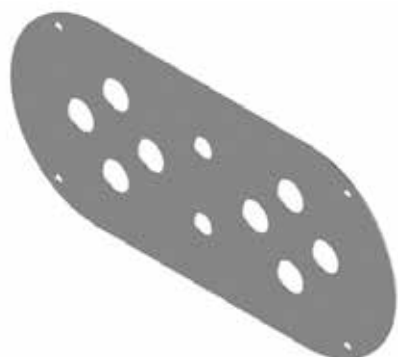

IC966023-14



IC966024-14



PRODUCT INFORMATION

Part #	Light Holes	Switch Hole	Finish	Fitment
IC966020-14	2 - Watermelon	No	#8 304 Polished Stainless Steel	Kenworth W900
IC966021-14	2 - Watermelon	Yes	#8 304 Polished Stainless Steel	Kenworth W900
IC966023-14	8 - 3/4 in. Mini Button	Yes	#8 304 Polished Stainless Steel	Kenworth W900
IC966024-14	8 - 3/4 in. Mini Button	No	#8 304 Polished Stainless Steel	Kenworth W900