

CLUTCH EXTENDERS

The patented Clutch Pedal Extender changes the position and increases the angle of the foot in relation to the floor for less strain on the ankle, thereby improving driver ergonomics.



PETERBILT



BEFORE



AFTER



PETERBILT
FITMENT
GUIDE



PRODUCT INFORMATION

Part #	Product	Size	Fitment
IC198001-xx	Clutch Pedal Extender	2 in.	Peterbilt 379, 386, 389

FINISH OPTIONS (-xx)

Add finish option number to end of part number for desired finish. (ex: IC198001-11)

Part #	Finish
11	Billet Aluminum
12	Chrome

IFTA PERMIT HOLDERS

The #8 304 Non-Directional Polished Stainless Steel IFTA Permit Holders provide a non-adhesive way to display your permits. For use with after-market angled exhaust clamps or sleeper mount see fitment. Mounts using existing hardware. Use with angle clamps only.

- Sold in Pairs



IC185001-14
16GA



IC185005-14
14GA



PETERBILT
FITMENT
GUIDE



PRODUCT INFORMATION

Part #	Product	Mount Information	Finish	Fitment
IC185001-14	1 - Permit IFTA Brackets	Angle Exhaust Clamp Mounted	#8 304 Polished Stainless Steel	Peterbilt 379, 386 & 389
IC185002-14	2 - Permits IFTA Brackets	Angle Exhaust Clamp Mounted	#8 304 Polished Stainless Steel	Peterbilt 379, 386 & 389
IC185003-14	1 - Permit IFTA Brackets	Cab Mounted	#8 304 Polished Stainless Steel	Peterbilt 579
IC185004-14	2 - Permits IFTA Brackets	Cab Mounted	#8 304 Polished Stainless Steel	Peterbilt 579
IC185005-14	1 - Permit IFTA Brackets	Angle Exhaust Clamp Mounted - Slim Series	#8 304 Polished Stainless Steel	Peterbilt 379, 386 & 389

GREASE GUARDS

This patented Grease Guard System prevents unwanted u-joint grease from splattering the underside of your rig. Expertly crafted from aluminum and brushed stainless steel. Complete kit includes guards for the hanger bearings and the front side of both rear axles.

- Fits Flex Air and Low Air Leaf
- DOES NOT fit Low – Low Air Leaf suspensions

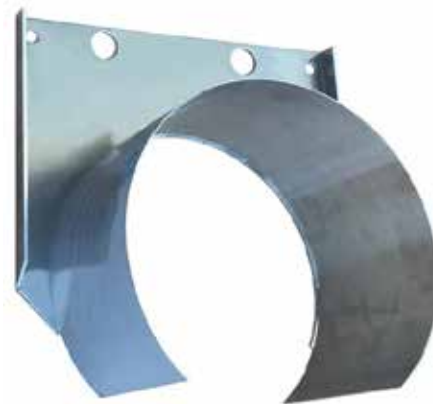

PETERBILT



BEFORE



AFTER



PETERBILT
FITMENT
GUIDE



PRODUCT INFORMATION



Part #	Product	Kit Information	Wheel Base	Finish	Fitment
IC186999-15	Grease Guards	(1) Hanger Bearing and (2) Drive Axles	280 in. - 292 in.	Gloss Black	Peterbilt 386, 389
IC186001-15	Grease Guards	(1) Hanger Bearing	280 in. - 292 in.	Gloss Black	Peterbilt 386, 389
IC186995-15	Grease Guards	(2) Hanger Bearings and (2) Drive Axles	292 in. - 315 in.	Gloss Black	Peterbilt 386, 389
IC186996-15	Grease Guards	(2) Hanger Bearings	292 in. - 315 in.	Gloss Black	Peterbilt 386, 389
IC186997-15	Grease Guards	(2) Drive Axles	280 in. - 315 in.	Gloss Black	Peterbilt 386, 389

REFRIGERATOR & MICROWAVE KITS



PETERBILT
FITMENT
GUIDE



Includes
Inverter Installation Kit



PRODUCT INFORMATION

Part #	Product	Storage	Dimensions	Installation	Fitment
IC184009-xx	Refrigerator & Microwave Kit	1 Drawer Storage	50.75 in. H x 16 in. x 18.5 in. D	Passenger Side	Peterbilt 379
IC184010-xx	Refrigerator & Microwave Kit	1 Drawer Storage	50.75 in. H x 16 in. x 18.5 in. D	Passenger Side	Peterbilt 389 2008-2015
IC184011-xx	Refrigerator & Microwave Kit	1 Drawer Storage	50.75 in. H x 16 in. x 18.5 in. D	Passenger Side	Peterbilt 389 2016+
IC184015-xx	Refrigerator & Microwave Kit	1 Drawer Storage	50.75 in. H x 16 in. x 18.5 in. D	Driver Side	Peterbilt 379, 386 & 389

Refrigerator Information

1.8 cu. ft. - Black Finish - 12v 3.2 Amp - No inverter needed

Microwave Information

750w 0.5 cu. ft. - 120v - Black Finish - Will Only Run with the Supplied Inverter

FINISH OPTIONS (-xx)

Add finish option number to end of part number for desired finish. (ex: IC184009-13)

Part #	Finish
13	Brushed Stainless Steel
15	Gloss Black

REFRIGERATOR KITS



PETERBILT

Our patented Refrigerator Kits offer storage solutions and the ability to simply install convenience into your Peterbilt! All storage units feature a one-piece, 3-drawer system ensuring the bottoms will never fall out. The ball bearing slides use Stay Closed Technology, which means the drawers will never open while driving down the road!



PETERBILT
FITMENT
GUIDE



PRODUCT INFORMATION

Part #	Dimensions	Storage	Includes	Installation	Fitment
IC184001-xx	50.75 in. x 16 in. 18.5 in.	3 Drawers	Trim Kit & Hardware	Driver Side	Peterbilt 379, 386 & 389
IC184002-xx	50.75 in. x 16 in. 18.5 in.	3 Drawers	Trim Kit & Hardware	Passenger Side	Peterbilt 379
IC184003-xx	50.75 in. x 16 in. 18.5 in.	3 Drawers	Trim Kit & Hardware	Passenger Side	Peterbilt 389 2008-2015
IC184004-xx	50.75 in. x 16 in. 18.5 in.	3 Drawers	Trim Kit & Hardware	Passenger Side	Peterbilt 389 2016+
IC184020-xx	50.75 in. x 16 in. 18.5 in.	3 Drawers	Trim Kit & Hardware	Driver Side	Peterbilt 389 - 70 in. / 78 in. Ultra Sleeper

Refrigerator Information

1.8 cu. ft. - Black Finish - 12v 3.2 Amp - No inverter needed

FINISH OPTIONS (-xx)

Add finish option number to end of part number for desired finish. (ex: IC184001-13)

Part #	Finish
13	Brushed Stainless Steel
15	Gloss Black

STORAGE SOLUTIONS

Our Peterbilt Storage Kits are ideal for keeping your truck organized. Our 5 drawer kit includes a 38 in. storage solution with an open shelf option above and a trim kit to give it the finished looked. The Table Top Option is only offered in the 5 drawer unit. All units feature 1-piece drawers, so the bottoms never fall out and ball bearing slides with “Stay-Closed” technology, so the drawers will never open while going down the road!



PETERBILT
FITMENT
GUIDE



PRODUCT INFORMATION

Part #	Product	Storage	Dimensions	Installation	Fitment
IC190017-xx	Storage Solutions	5-Drawer Kit with Top Shelf	14 in. W x 38 in. T	Driver Side	Peterbilt 379, 386 & 389
IC190018-xx	Storage Solutions	5-Drawer Kit with Top Shelf	14 in. W x 38 in. T	Passenger Side	Peterbilt 379
IC190019-xx	Storage Solutions	5-Drawer Kit with Table Top & Top Shelf	14 in. W x 38 in. T	Driver Side	Peterbilt 379, 386 & 389
IC190020-xx	Storage Solutions	5-Drawer Kit with Table Top & Top Shelf	14 in. W x 38 in. T	Passenger Side	Peterbilt 379
IC190021-xx	Storage Solutions	5-Drawer Kit with Top Shelf	14 in. W x 38 in. T	Driver Side	Peterbilt 379, 386 & 389
IC190022-xx	Storage Solutions	5-Drawer Kit	14 in. W x 38 in. T	Passenger Side	Peterbilt 379, 386 & 389
IC190023-xx	Storage Solutions	5-Drawer Kit with Table Top & Top Shelf	14 in. W x 38 in. T	Driver Side	Peterbilt 379,386 & 389
IC190024-xx	Storage Solutions	5-Drawer Kit with Table Top	14 in. W x 38 in. T	Passenger Side	Peterbilt 379, 386 & 389

FINISH OPTIONS (-xx)

Add finish option number to end of part number for desired finish. (ex: IC190017-13)

Part #	Finish
13	Brushed Stainless Steel
15	Gloss Black

SEAT BASE ADAPTERS



PETERBILT

Our patented Seat Base Adapters are your solution for added leg room and adapting after-market or OEM seats without drilling added holes into your floor! Each Seat Base Adapter is manufactured to match your specific brand of seat making installation simple. Adapters come with all mounting hardware included!



PETERBILT
FITMENT
GUIDE



PRODUCT INFORMATION

Part #	Seat Information	Fitment
IC199001-xx	8 in. OEM/National & Knodler	Peterbilt 379, 386, 389
IC199001-xx	12 in. Sears Atlas WITH Riser	Peterbilt 379, 386, 389
IC199001-xx	10 in. Bostrom Pro Ride with Standard Base	Peterbilt 379, 386, 389
IC199002-xx	10 in. Bostrom Wide Ride	Peterbilt 379, 386, 389
IC199002-xx	10 in. Bostrom ProRide with Lo Base	Peterbilt 379, 386, 389
IC199002-xx	8 in. Seats Inc. Legacy LoPro (Seat Build Date Pre July 1, 2018)	Peterbilt 379, 386, 389
IC199003-xx	10 in. Seats Inc. Legacy Gold/Silver	Peterbilt 379, 386, 389
IC199006-xx	10 in. National Seating Series 2000 Ultra Ride	Peterbilt 379, 386, 389
IC199004-xx	12 in. Sears Atlas WITHOUT Riser	Peterbilt 379, 386, 389
IC199008-xx	Seats Inc. Legacy LoPro (Seat Build Date Post July 1, 2018)	Peterbilt 379, 386, 389
IC199008-xx	Legacy Pinnacle	Peterbilt 379, 386, 389
IC199010-xx	12 in. Seats Inc. Legacy Gold/Silver Series Peterbilt 579	Peterbilt 579
IC199011-xx	Seats Inc. Legacy LoPro (Seat Build Date Post July 1, 2018)	Peterbilt 579
IC199011-xx	Legacy Pinnacle for Peterbilt 579	Peterbilt 579
IC199012-xx	12 in. Sears Atlas for Peterbilt 579	Peterbilt 579
IC199013-xx	Seats Inc. Legacy LoPro (Seat Build Date Pre July 1, 2018)	Peterbilt 579
IC199013-xx	10 in. Bostrom Wide Ride for Peterbilt 579	Peterbilt 579
IC199005-xx	14 in. National Lo Profile Seat Base	Peterbilt 379, 386, 389



FINISH OPTIONS (-xx)

Add finish option number to end of part number for desired finish. (ex: IC199001-11)

Part #	Finish
11	Billet Aluminum
12	Chrome
15	Gloss Black
16	Red Baron
17	Crystal White
18	PO Blue

CAB & COWL PANELS



Peterbilt 389 Cab & Cowl Panels are expertly crafted from #8 304 Stainless Steel and feature 2-Into-1 Bend. Patented mounting system allows for easy installation. Available in 3-1/2 in., 4-1/2 in. and 5-1/2 in. Drops with 3/4 in. Light Holes located on bottom edge of all Cab & Cowl Panels. Custom Light and Drop Designs Available. Need Lights: Order our All-In-One Light Kit. Kit includes lights and wire harness for ease of installation.

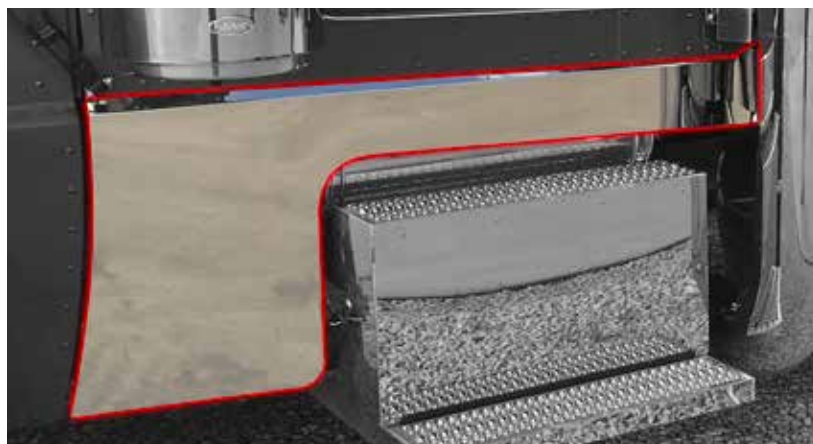

PETERBILT
FITMENT
GUIDE

PRODUCT INFORMATION

Finish: #8 304 Polished Stainless Steel

Part #	Fitment	Information	Height	Light Holes
IC171001-14-xx	389 Glider or DEF with Horizontal Exhaust	Full Wrap	3-1/2 in.	46
IC171002-14-xx		Full Wrap	4-1/2 in.	46
IC171003-14-xx		Full Wrap	5-1/2 in.	44
IC171015-14-xx	389 Glider with Stock Cowls	Straight Cut	3-1/2 in.	28
IC171016-14-xx		Straight Cut	4-1/2 in.	28
IC171017-14-xx		Straight Cut	5-1/2 in.	28
IC171020-14-xx	2015-2017 389 DEF with Conventional Exhaust	Straight Cut	3-1/2 in.	42
IC171021-14-xx		Straight Cut	4-1/2 in.	42
IC171022-14-xx		Straight Cut	5-1/2 in.	41
IC171025-14-xx	2015-2017 389 DEF with Horizontal or Conventional Exhaust with Stock Cowls	Straight Cut	3-1/2 in.	28
IC171026-14-xx		Straight Cut	4-1/2 in.	28
IC171027-14-xx		Straight Cut	5-1/2 in.	28
IC171029-14-xx	2015-2017 389 DEF with Aftermarket Exhaust and Box Forward Position	Full Wrap	3-1/2 in.	46
IC171030-14-xx		Full Wrap	4-1/2 in.	46
IC171031-14-xx		Full Wrap	5-1/2 in.	45
IC171070-14-xx	2018 & Newer 389 DEF with Conventional Exhaust	Straight Cut	3-1/2 in.	42
IC171071-14-xx		Straight Cut	4-1/2 in.	42
IC171072-14-xx		Straight Cut	5-1/2 in.	41
IC171075-14-xx	2018 & Newer DEF with Horizontal or Conventional Exhaust with Stock Cowls	Straight Cut	3-1/2 in.	28
IC171076-14-xx		Straight Cut	4-1/2 in.	28
IC171077-14-xx		Straight Cut	5-1/2 in.	28
IC171079-14-xx	2018 & Newer 389 DEF with Aftermarket Exhaust and Box Forward Position	Full Wrap	3-1/2 in.	46
IC171080-14-xx		Full Wrap	4-1/2 in.	46
IC171081-14-xx		Full Wrap	5-1/2 in.	45

LIGHT OPTIONS (-xx)

Add light option number to end of part number for desired light color.
(ex: IC171001-14-97)

Part #	Product
97	Amber Lens / Amber LED Light Kit
96	Clear Lens / Amber LED Light Kit
95	Red Lens / Red LED
94	Clear Lens / Red LED
93	Dual Revolution - Amber/Blue
92	Dual Revolution - Amber/Green
91	Dual Revolution - Amber/Purple
90	Dual Revolution - Amber/Red
89	Dual Revolution - Amber/White
88	Dual Revolution - Red/Blue
87	Dual Revolution - Red/Green
86	Dual Revolution - Red/Purple
85	Dual Revolution - Red/White

SLEEPER PANELS

Peterbilt 389 Sleeper Panels are expertly crafted from #8 304 Stainless Steel. Our Patented Mounting System allows for easy installation. Available in 3-1/2 in., 4-1/2 in. and 5-1/2 in. Drops with 3/4 in. Light Holes located on bottom edge of all sleeper panels. Custom Light and Drop Designs Available. Need Lights: Order our All-In-One Light Kit which includes the lights and wire harness.



PETERBILT

PRODUCT INFORMATION

Finish: #8 304 Polished Stainless Steel

Part #	Fitment	Sleeper Size	Extensions	Drop	Light Holes
IC170001-14-xx	Full Wrap - Stock Exhaust	63 in. / 72 in.	-	3-1/2 in.	46
IC170003-14-xx		63 in. / 72 in.	-	4-1/2 in.	44
IC170005-14-xx		63 in. / 72 in.	-	5-1/2 in.	44
IC170007-14-xx	Full Wrap - Aftermarket Exhaust	63 in. / 72 in.	-	3-1/2 in.	50
IC170009-14-xx		63 in. / 72 in.	-	4-1/2 in.	48
IC170011-14-xx		63 in. / 72 in.	-	5-1/2 in.	48
IC170020-14-xx	Full Wrap - Stock Exhaust	48 in. / 58 in.	-	3-1/2 in.	34
IC170022-14-xx		48 in. / 58 in.	-	4-1/2 in.	34
IC170024-14-xx		48 in. / 58 in.	-	5-1/2 in.	34
IC170026-14-xx	Full Wrap - Aftermarket Exhaust	48 in. / 58 in.	-	3-1/2 in.	38
IC170028-14-xx		48 in. / 58 in.	-	4-1/2 in.	38
IC170030-14-xx		48 in. / 58 in.	-	5-1/2 in.	38
IC170040-14-xx	Full Wrap - Stock Exhaust	36 in. / 44 in.	-	3-1/2 in.	28
IC170042-14-xx		36 in. / 44 in.	-	4-1/2 in.	28
IC170044-14-xx		36 in. / 44 in.	-	5-1/2 in.	28
IC170046-14-xx	Full Wrap - Aftermarket Exhaust	36 in. / 44 in.	-	3-1/2 in.	35
IC170048-14-xx		36 in. / 44 in.	-	4-1/2 in.	35
IC170050-14-xx		36 in. / 44 in.	-	5-1/2 in.	35
IC170060-14-xx	Front Wrap - Stock Exhaust	70 in. / 78 in.	2 in.	3-1/2 in.	46
IC170062-14-xx		70 in. / 78 in.	2 in.	4-1/2 in.	46
IC170064-14-xx		70 in. / 78 in.	2 in.	5-1/2 in.	46
IC170066-14-xx	Front Wrap - Aftermarket Exhaust	70 in. / 78 in.	2 in.	3-1/2 in.	50
IC170068-14-xx		70 in. / 78 in.	2 in.	4-1/2 in.	50
IC170070-14-xx		70 in. / 78 in.	2 in.	5-1/2 in.	50
IC170080-14-xx	Front Wrap - Stock Exhaust	70 in. / 78 in.	12 in.	3-1/2 in.	46
IC170082-14-xx		70 in. / 78 in.	12 in.	4-1/2 in.	46
IC170084-14-xx		70 in. / 78 in.	12 in.	5-1/2 in.	46
IC170086-14-xx	Front Wrap - Aftermarket Exhaust	70 in. / 78 in.	12 in.	3-1/2 in.	50
IC170088-14-xx		70 in. / 78 in.	12 in.	4-1/2 in.	50
IC170090-14-xx		70 in. / 78 in.	12 in.	5-1/2 in.	50



PETERBILT
FITMENT
GUIDE

LIGHT OPTIONS (-xx)

Add light option number to end of part number for desired light color. (ex: IC170001-14-97)



Part #	Product
97	Amber Lens / Amber LED Light Kit
96	Clear Lens / Amber LED Light Kit
95	Red Lens / Red LED
94	Clear Lens / Red LED
93	Dual Revolution - Amber/Blue
92	Dual Revolution - Amber/Green
91	Dual Revolution - Amber/Purple
90	Dual Revolution - Amber/Red
89	Dual Revolution - Amber/White
88	Dual Revolution - Red/Blue
87	Dual Revolution - Red/Green
86	Dual Revolution - Red/Purple
85	Dual Revolution - Red/White



*Red Denotes Product

SLEEPER AIR BAG COVERS

Iowa Customs Sleeper Air Bag Covers are specifically designed to cover up the air bags on your sleeper!



PETERBILT
FITMENT
GUIDE



PRODUCT INFORMATION

Part #	Product	Sleeper Dimensions	Information	Fitment
IC181001-xx	Air Bag Covers	48 in. / 52 in. and 63 in. / 72 in.	Sold as Pair	Peterbilt 386 & 389
IC181003-xx	Air Bag Covers	70 in. / 78 in.	Sold as Pair	Peterbilt 389

FINISH OPTIONS (-xx)

Add finish option number to end of part number for desired finish. (ex: IC181001-13)

Part #	Finish
21	Paintable Finish
14	#8 304 Non-Directional Polished Stainless Steel

BATTERY, BOOT & TOOLBOX COVERS

Iowa Customs 18GA #8 304 Non-Directional Polished Stainless Steel Boot Box Cover are expertly manufactured to create a superior fit. Six configurations are available including - Peterbilt Battery Box, Tool/Boot Box, 2015-2017 and 2018+ DPF Step Box Center Panels.

Keep your steps looking sharp and stay safe! Iowa Customs Lower Replacement Steps are sold individually and designed to keep you steady getting in and out. Crafted from our corrosion resistant #8 304 Non Directional Polished Stainless Steel, our steps will stay guarded from rough weather conditions and are made to last.

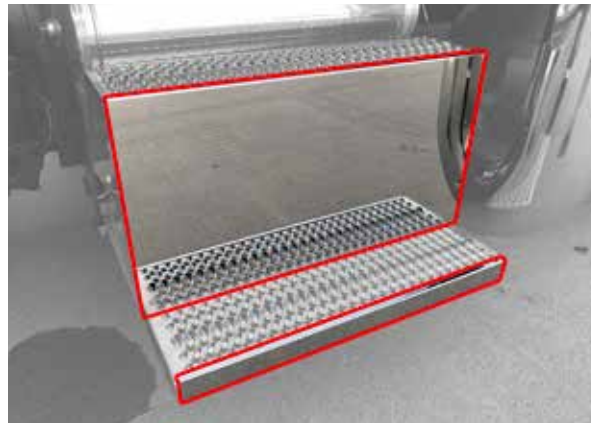
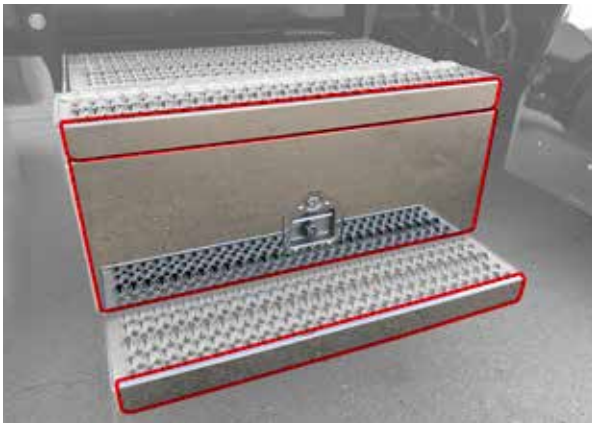

PETERBILT
FITMENT
GUIDE



PRODUCT INFORMATION

Finish: #8 304 Polished Stainless Steel

Part #	Product	Information	Fitment
IC173001-14	Boot/Tool Box Kit	(1) Long Step Trim, (1) Short Step Trim & (1) Tool Box Handle Cutout Center Panel	Peterbilt 379/389
IC173002-14	Battery Box Kit	(1) Step Trims & (1) Combo Step Center Panel	Peterbilt 379/389
IC173003-14	DPF Cover Kit	(1) Step Trim & (1) Center Panel	Peterbilt 389 Passenger 2015-2017
IC173004-14	DPF Cover Kit	(1) Step Trim & (1) Center Panel	Peterbilt 389 Passenger 2018+
IC173100-14	Battery Box Panel	Dimensions: 30.625 in. L x 12.75 in. T	See QR Code
IC173101-14	Permit Panel Cover Kit	Dimensions Toolbox: 30.625 in. L x 10 in. T) Dimensions Battery Box: 30.625 in. L x 12.75 in. T	See QR Code
IC173102-14	Lower Replacement Step	Dimensions: 30.375 in. L x 7.125 in. W x 2 in. T	See QR Code

SHOCKBOX COVERS



Iowa Customs Ghost Mount Internal Structure is easily installed without drilling any holes or double-sided tape. The paintable, smooth aluminum or #8 Non-Directional Polished Stainless Steel box covers the sleeper shock suspension. A clean, finished look when installed with our sleeper air bag covers.



PETERBILT
FITMENT
GUIDE



(5) - 4 in. light holes
IC172001-21

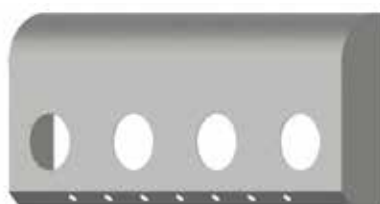

(5) - 4 in. light holes with 7 bullets
IC172002-21



(4) - 4 in. light holes
IC172003-21



(4) - 4 in. light holes with 7 bullets
IC172004-21



(10) 3/4 in. light holes on 45° face
IC172005-21



(7) 3/4 in. light holes on 45° face
IC172007-21



Blank
IC172020-14



Blank
IC172008-21



(4) - 4 in. light holes
IC172018-21

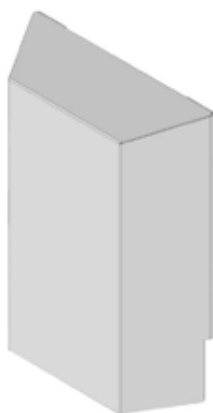

3M VHB
Tape Mounted
Tool-Less
Installation
IC172200-14

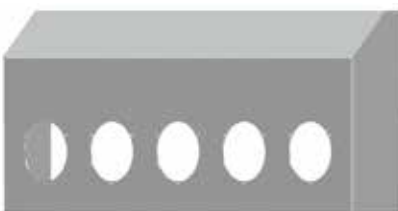

(5) - 4 in. light holes
IC172021-14



(4) - 4 in. light holes
IC172022-14



(3) - 4 inch light holes
IC172017-21

**Fitment:**



Peterbilt 389 and Peterbilt 386

FINISHES (-xx)

Part #	Design	Product
14	45° Top	#8 304 Non-Directional Polished Stainless Steel
21	Round Top	Smooth Aluminum / Paintable Finish

PRODUCT INFORMATION

Fitment: Peterbilt 389 and Peterbilt 386

Part #	Sleep Size	Design Info	Light Information
IC172001-21	48 in. / 52 in. & 63 in. / 72 in.	Round Top	(5) 4 in. Lights on Face Only 
IC172002-21	48 in. / 52 in. & 63 in. / 72 in.	Round Top	(5) 4 in. Lights on Face & (7) 3/4 in. Lights on 45° Flange
IC172003-21	48 in. / 52 in. & 63 in. / 72 in.	Round Top	(4) 4 in. Lights on Face Only 
IC172004-21	48 in. / 52 in. & 63 in. / 72 in.	Round Top	(4) 4 in. Lights on Face & (7) 3/4 in. Lights on 45° Flange
IC172005-21	48 in. / 52 in. & 63 in. / 72 in.	Round Top	(10) 3/4 in. Lights on Face Only
IC172006-21	48 in. / 52 in. & 63 in. / 72 in.	Round Top	(10) 3/4 in. Lights on Face & (7) 3/4 in. Lights on 45° Flange
IC172007-21	48 in. / 52 in. & 63 in. / 72 in.	Round Top	(7) 3/4 in. Lights on 45° Flange Only
IC172008-21	48 in. / 52 in. & 63 in. / 72 in.	Round Top	Blank with No Light Holes
IC172020-14	48 in. / 52 in. & 63 in. / 72 in.	45° Top	No Holes
IC172021-14	48 in. / 52 in. & 63 in. / 72 in.	45° Top	(5) 4 in. Lights on Face
IC172022-14	48 in. / 52 in. & 63 in. / 72 in.	45° Top	(4) 4 in. Lights on Face
IC172015-21	48 in. / 52 in. & 63 in. / 72 in.	Round Top	Center Recessed Blank with No Light Holes
IC172016-21	48 in. / 52 in. & 63 in. / 72 in.	Round Top	Center Recessed with (2) 4 in. Light Holes
IC172017-21	48 in. / 52 in. & 63 in. / 72 in.	Round Top	Center Recessed with (3) 4 in. Light Holes
IC172018-21	48 in. / 52 in. & 63 in. / 72 in.	Round Top	Center Recessed with (4) 4 in. Light Holes
IC172041-21	70 in. / 78 in.	Round Top	(5) 4 in. Lights on Face Only
IC172042-21	70 in. / 78 in.	Round Top	(5) 4 in. Lights on Face & (7) 3/4 in. Lights on 45° Flange
IC172043-21	70 in. / 78 in.	Round Top	(4) 4 in. Lights on Face Only
IC172044-21	70 in. / 78 in.	Round Top	(4) 4 in. Lights on Face & (7) 3/4 in. Lights on 45° Flange
IC172045-21	70 in. / 78 in.	Round Top	(10) 3/4 in. Lights on Face Only
IC172046-21	70 in. / 78 in.	Round Top	(10) 3/4 in. Lights on Face & (7) 3/4 in. Lights on 45° Flange
IC172047-21	70 in. / 78 in.	Round Top	(7) 3/4 in. Lights on 45° Flange Only
IC172048-21	70 in. / 78 in.	Round Top	Blank with No Light Holes
IC172055-21	70 in. / 78 in.	Recessed Center Round Top	Blank with No Light Holes
IC172056-21	70 in. / 78 in.	Recessed Center Round Top	(2) 4 in. Light Holes
IC172057-21	70 in. / 78 in.	Recessed Center Round Top	(3) 4 in. Light Holes
IC172058-21	70 in. / 78 in.	Recessed Center Round Top	(4) 4 in. Light Holes
IC172060-14	70 in. / 78 in.	45° Top	No Holes
IC172061-14	70 in. / 78 in.	45° Top	(5) 4 in. Lights on Face
IC172062-14	70 in. / 78 in.	45° Top	(4) 4 in. Lights on Face

Part #	Product	Information	Finish	Fitment
IC172200-14	Shock Box Cover for Rear Sleeper	Sold Individually	#8 304 Polished Stainless Steel	See QR Code

WINDOW CHOPS

Want that Chopped Top Look? Iowa Customs Window Chops create just that! Design for use on trucks with cab mounted mirrors. Our window chops are available in a paintable finish or #8 304 Non-Directional Polished Stainless Steel.

- Sold in pairs



PETERBILT
FITMENT
GUIDE



**304 CORROSION
RESISTANT**
304 Stainless Steel | Rust Free | Weather Proof

PRODUCT INFORMATION

Part #	Product	Fitment
IC180001-xx	4 in. Window Chops	Peterbilt 389
IC180002-xx	5 in. Window Chops	Peterbilt 389
IC180003-xx	6 in. Window Chops	Peterbilt 389
IC180004-xx	7 in. Window Chops	Peterbilt 389
IC180005-xx	8 in. Window Chops	Peterbilt 389

FINISH OPTIONS (-xx)

Add finish option number to end of part number for desired finish. (ex: IC180001-14)

Part #	Finish
14	#8 304 Non-Directional Polished Stainless Steel
21	Paintable Finish

GRILL INSERTS

Custom
OPTIONS AVAILABLE



Iowa Custom's 14GA #8 304 Non-Directional Stainless Steel Punched Grill OEM Replacement is engineered to withstand the everyday work load all while still standing out. Our grills have an Oval Design or a 3/8 in. Round Punched Design with Revers Convex Technology which helps to maintain strength when installed.

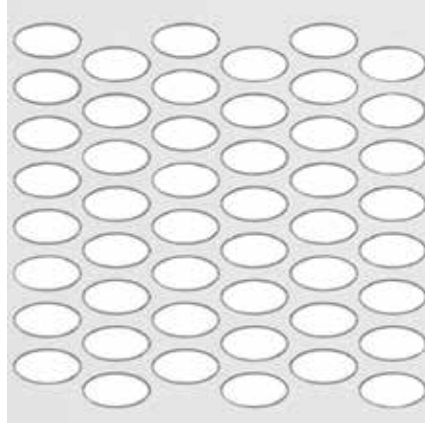
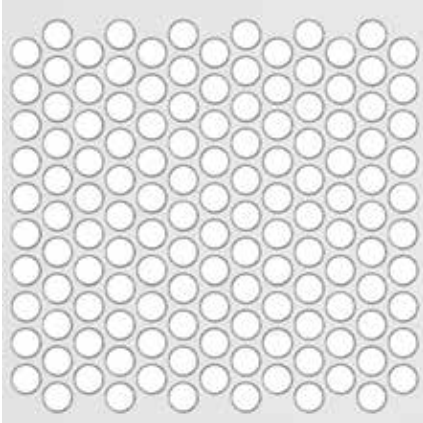

PETERBILT
FITMENT
GUIDE

PETERBILT



PRODUCT INFORMATION

Part #	Product	Kit Information	Finish	Fitment
IC176100-14	Grill Inserts	14GA Punched Grill with 3/8 in. Round Hole Design	#8 304 Polished Stainless Steel	Peterbilt 389
IC176101-14	Grill Inserts	14GA Punched Grill with Small Oval Hole Design	#8 304 Polished Stainless Steel	Peterbilt 389
IC176125-14	Grill Inserts	14GA Punched Grill with 3/8 in. Round Hole Design	#8 304 Polished Stainless Steel	Peterbilt 379
IC176126-14	Grill Inserts	14GA Punched Grill with Small Oval Hole Design	#8 304 Polished Stainless Steel	Peterbilt 379

DEF TANK ACCESSORIES

Iowa Customs' DEF Bracket Cover System covers the OEM DEF Tank Brackets allowing you to further enhance the look of your truck. Expertly crafted from 16GA #8 304 Non-Directional Polished Stainless Steel, the DEF Bracket Covers and DEF Tank Top mount directly to the brackets utilizing the OEM hardware. Depending on the location of your DEF tank, the optional upper tank cover helps further cover the DEF Tank and its components to further complete the look.



PETERBILT
FITMENT
GUIDE



PRODUCT INFORMATION

Part #	Product	Tank Size	Covers	Finish	Fitment
IC168001-14	DEF Tank Accessories	Medium & Large	Side Covers	#8 304 Polished Stainless Steel	Peterbilt 389 - 2022 or newer
IC168002-14	DEF Tank Accessories	Large	Top Cover	#8 304 Polished Stainless Steel	Peterbilt 389 - 2022 or newer

OEM FRONT FLAP WEIGHTS



PETERBILT

Iowa Customs OEM Front Curl Free Flap weight fits precisely to the contour and inset of the flap for a very smooth fit and finish. Constructed from 16GA #8 304 Non-Directional Polished Stainless Steel and includes the back plate and polished stainless steel hardware for years and years of trouble-free use.

- Sold in Pairs
- Hardware Included
- Back Plate Included



PETERBILT
FITMENT
GUIDE



PRODUCT INFORMATION

Part #	Product	Size	Finish	Fitment
IC189001-14	OEM Front Fender Flap Weight Kit	3 in. x 14 in.	#8 304 Polished Stainless Steel	Peterbilt 389

REMOTE LUBE MOUNT BRACKETS

Iowa Custom's Remote Lube Mount Bracket make maintaining a breeze. Centrally locate all of your important grease zerk's all in one easy to install bracket. Marked locations include (2) Clutch Linkage, (2) Cross Shaft & (1) Release Bearing. Expertly crafted from #8 304 Non-Directional Polished Stainless Steel. Does NOT include Grease Zerks or grease lines.



PRODUCT INFORMATION

Part #	Product	Finish	Fitment
IC169001-14	Remote Lube Mount Bracket	#8 304 Polished Stainless Steel	See QR Code

FENDER GUARDS & SHIELDS

Designed specifically for the guarding of your fenders! Expertly crafted from 304 Corrosion Resistant #8 Non-Directional Stainless Steel, these 14GA fender shields will stand up to all the elements. Sold as pairs and hardware is not included! Please refer to the fitment guide to confirm fitment.

304 CORROSION RESISTANT
304 Stainless Steel | Rust Free | Weather Proof



IC164015-14



IC164016-14



PETERBILT
FITMENT
GUIDE



PRODUCT INFORMATION

Fitment: See QR Code

Part #	Product	Information	Side Information	Finish
IC164015-14	Peterbilt 379 Fender Shield	Sold in Pairs	(1) Left, (1) Right	#8 304 Polished Stainless Steel
IC164016-14	Fender Guards for Double JJ Blinker Bar	Sold in Pairs	(1) Left, (1) Right	#8 304 Polished Stainless Steel

HOOD ACCESSORIES

Iowa Customs Hood Accessories are available in a few different variations. Each trim piece is crafted from #8 304 Non-Directional Corrosion Resistant Stainless Steel to withstand all the elements. The center hood trim is expertly engineered to fit perfectly on-top of the hood whereas the side hood trims have the rivet dome integrated into the part for that perfect fit. Center Trim is sold each and side hood trims are sold as pairs. Please refer to fitment guide to confirm fitment.



IC164001-14



IC164002-14



IC164010-14

PRODUCT INFORMATION

Part #	Product	Dimples	Information	Side Information	Finish	Fitment
IC164001-14	Hood Extension Panels	No	Sold in Pairs	(1) Left, (1) Right	#8 304 Polished Stainless Steel	See QR Code
IC164002-14	Hood Extension Panels	Yes	Sold in Pairs	(1) Left, (1) Right	#8 304 Polished Stainless Steel	See QR Code
IC164010-14	Wide Top of Hood Trim	Yes	Sold Individually	(1) Center	#8 304 Polished Stainless Steel	See QR Code

SLEEPER WINDOW TRIMS

Crafted from 304 Corrosion Resistant #8 Non-Directional Stainless Steel Finish, the Iowa Customs Sleeper Door Trims comes in two different Kits – Sleeper Door Window Trim only or the Sleeper Door Trim and Surrounds. These Kits fit perfectly and attach with 3M VHB Tape so it allows for a tool-less installation.

- Sold in Pairs

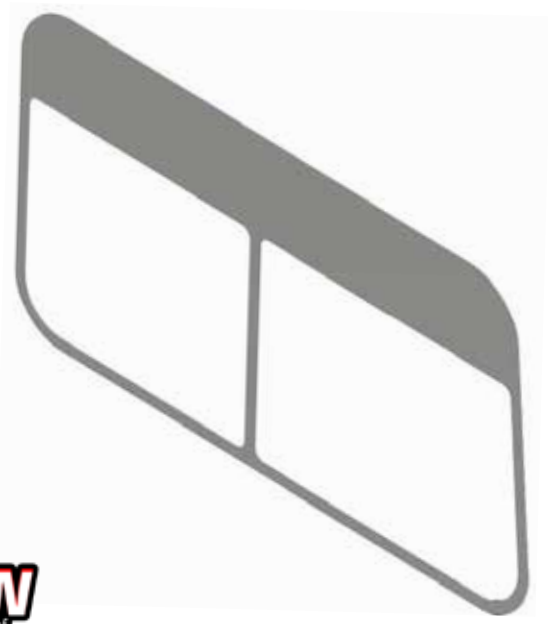

PETERBILT
FITMENT
GUIDE

PRODUCT INFORMATION

Fitment: See QR Code

Part #	Product	Side Information	Finish	Fitment
IC160001-14	Sleeper Window Trim with 5 in. Chopped Look	(1) Left, (1) Right	#8 304 Polished Stainless Steel	See QR Code



WINDOW TRIM KITS

Peterbilt Front Window Trims from Iowa Customs fits around on the factory trim for an OEM fit and finish. Crafted from #8 304 Non-Directional Corrosion Resistant Stainless Steel, these are sold with (1) Drivers & (1) Passenger Side Window Trim with (1) Center Post Trim to complete the set. Please refer to fitment guide for proper fitment.

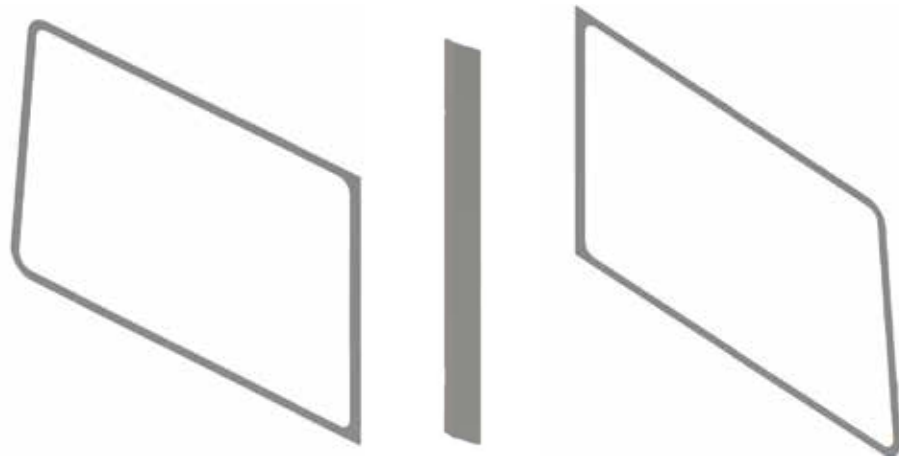

PRODUCT INFORMATION

Part #	Product	Information	Finish	Fitment
IC180100-14	Window Trim Kit	(1) Left, (1) Right and (1) Center Trim	#8 304 Polished Stainless Steel	See QR Code

FRAME COVERS

Iowa Customs Frame Covers and Overhead Consoles are expertly crafted from 304 Corrosion resistant #8 Finish Stainless Steel and adds another level of customization to your rig. Please refer to our fitment guide for correct fitment.



IC161001-14



PETERBILT
FITMENT
GUIDE



PRODUCT INFORMATION

Part #	Product	Finish	Fitment
IC161001-14	Frame Cover with Notch Cutout for Steel Crossmembers	#8 304 Polished Stainless Steel	See QR Code

OVERHEAD CONSOLES

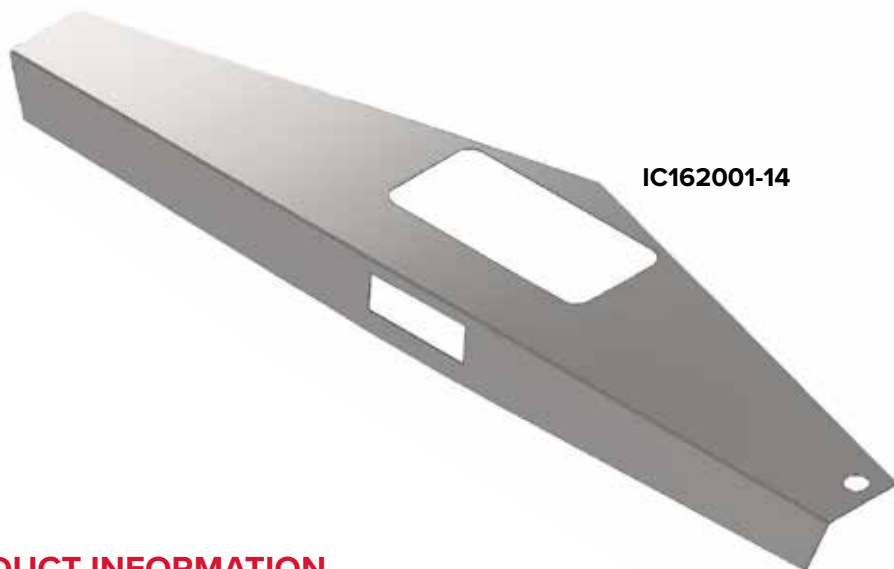

IC162001-14



PRODUCT INFORMATION

Part #	Product	Finish	Fitment
IC162001-14	Overhead Console Trim	#8 304 Polished Stainless Steel	See QR Code

VISORS

Iowa Customs Drop Visor engineered from Corrosion Resistant #8 304 Non-Directional Stainless steel comes in a variety of sizes and styles. The Standard 2-Piece configuration is available in either a Standard Mount or Blind Mound option.

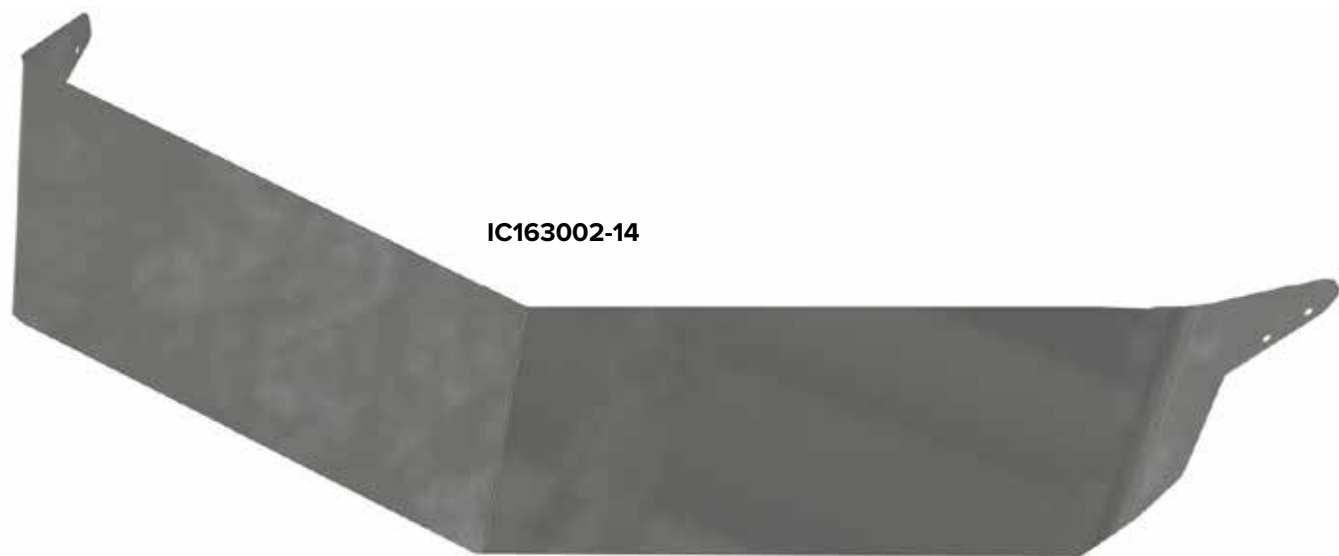

IC163002-14



PETERBILT
FITMENT
GUIDE



PRODUCT INFORMATION

Part #	Product	Finish	Fitment
IC163002-14	11 in. Blind Mount Drop Visor	#8 304 Polished Stainless Steel	See QR Code

AIR CLEANER PANELS

Crafted from 304 Corrosion Resistant #8 Non-Directional Stainless-Steel Finish, the Iowa Customs Peterbilt Air Cleaner Panels adds the perfect detail to your rig! Available in multiple hole configurations, light hole counts and fitments. Please refer to our fitment guide for correct fitment.



PETERBILT
FITMENT
GUIDE



IC167001-14



IC167002-14



IC167005-14



IC167006-14



IC167003-14



IC167004-14



IC167020-14



IC167021-14

PRODUCT INFORMATION

Lights not included

Part #	Product	Light Holes	Installation	Finish	Fitment
IC167001-14	Air Cleaner Light Panels	(7) - 3/4 in. Light Holes	Front Side	#8 304 Polished Stainless Steel	See QR Code
IC167002-14	Air Cleaner Light Panels	(7) - 3/4 in. Light Holes	Back Side	#8 304 Polished Stainless Steel	See QR Code
IC167003-14	Air Cleaner Light Panels	(5) - 3 in. Watermelon Light Holes	Front Side	#8 304 Polished Stainless Steel	See QR Code
IC167004-14	Air Cleaner Light Panels	No Light Holes	Back Side	#8 304 Polished Stainless Steel	See QR Code
IC167005-14	Air Cleaner Light Panels	(10) - 3/4 in. Light Holes	Front Side	#8 304 Polished Stainless Steel	See QR Code
IC167006-14	Air Cleaner Light Panels	(10) - 3/4 in. Light Holes	Back Side	#8 304 Polished Stainless Steel	See QR Code
IC167020-14	Air Cleaner Light Panels	(8) 2 in. Light Holes	Back Side	#8 304 Polished Stainless Steel	See QR Code
IC167021-14	Air Cleaner Light Panels	(8) 2 in. Light Holes	Front Side	#8 304 Polished Stainless Steel	See QR Code

FUEL TANK SADDLE COVERS

Fuel Tank Saddle Covers hide the mechanical workings of the tank straps. If you are looking for ultimate customization, look no further. Iowa Customs craftsmanship and manufactured from 304 Corrosion Resistant #8 Non-Directional Stainless Steel, you can be sure that your rig will look Top Notch. Our exclusive “Tool-Less” installation, utilizes 3M VHB tape so no tools are needed for installation. Please refer to our fitment guide to confirm fitment.



IC168010-14



IC168011-14



PETERBILT
FITMENT
GUIDE



PRODUCT INFORMATION



Part #	Product	Radius	Information	Finish	Fitment
IC168010-14	Fuel Tank Saddle Cover	Full Radius	Sold in Pairs	#8 304 Polished Stainless Steel	See QR Code
IC168011-14	Fuel Tank Saddle Cover	Partial Radius	Sold in Pairs	#8 304 Polished Stainless Steel	See QR Code

FRONT BUMPER ACCESSORIES

Front bumper accessories are here! Iowa Customs Tow Pin Covers are expertly crafted from 304 Corrosion resistant #8 Finish Stainless Steel and adds another level of customization to your rig. Please refer to our fitment guide for correct fitment.



PETERBILT
FITMENT
GUIDE



IC165001-14

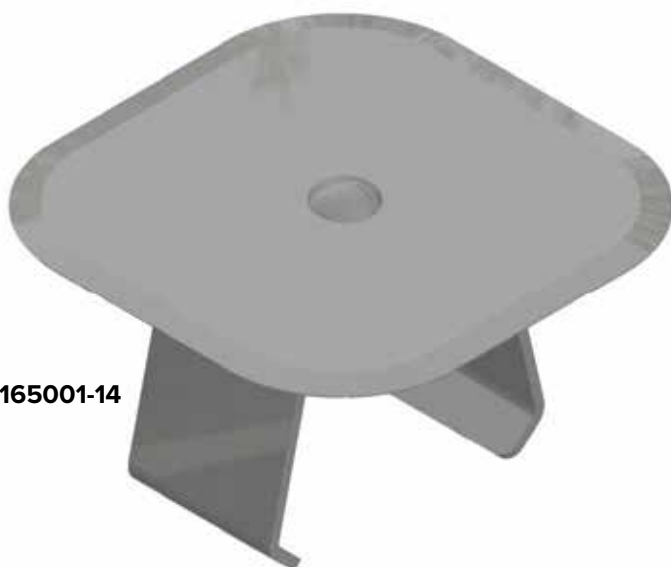

IC165002-14

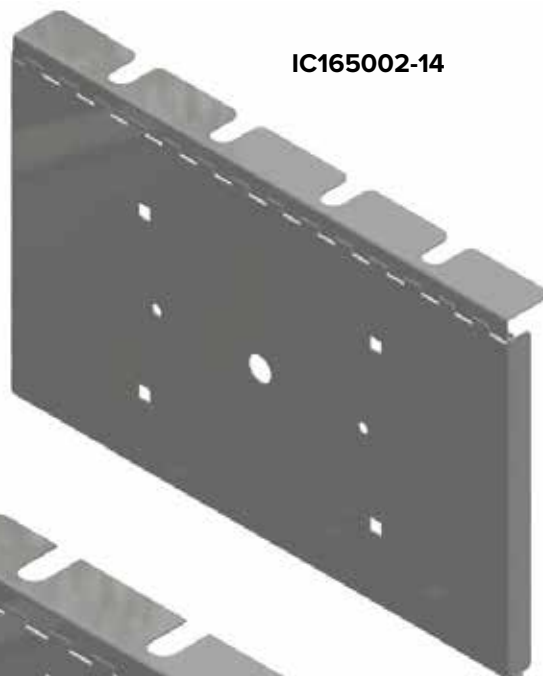

IC165003-14

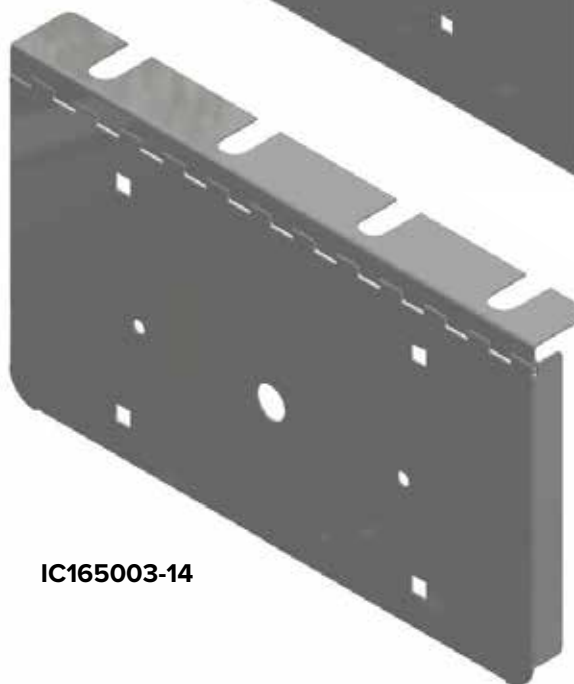

304 CORROSION RESISTANT
304 Stainless Steel | Rust Free | Weather Proof

PRODUCT INFORMATION

Part #	Product	Finish	Fitment
IC165001-14	Tow Pin Cover	#8 304 Polished Stainless Steel	See QR Code
IC165002-14	Extra Small Tow Pin Cover	#8 304 Polished Stainless Steel	See QR Code
IC165003-14	License Plate Tow Pin Cover	#8 304 Polished Stainless Steel	See QR Code

ABOVE DOOR DOME PANELS

Interior Above Door Dome Panels are exactly what you're looking for to customize your rigs interior! Designed and crafted from 304 Corrosion Resistant #8 Non-Directional Stainless Steel, the Iowa Customs Door Dome Panels install in your existing truck dome mounting holes, so no drilling is required. Additionally, there are multiple light hole configurations!

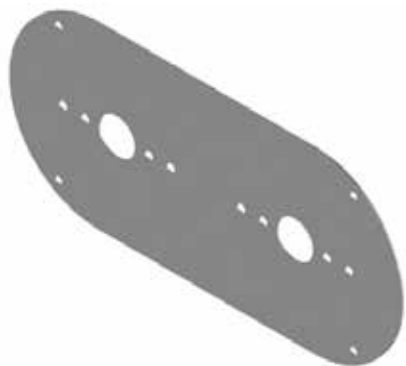

IC966020-14

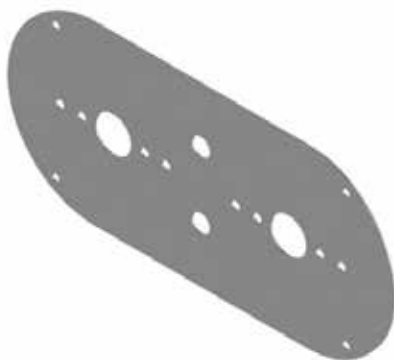

IC966021-14

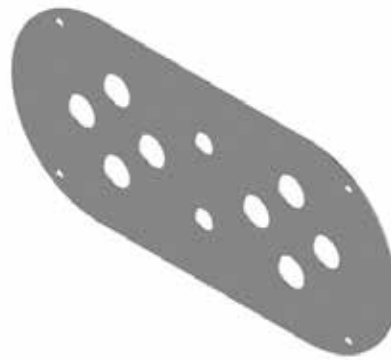

IC966023-14



IC966024-14



IC166022-14



PETERBILT
FITMENT
GUIDE



**304 CORROSION
RESISTANT**
304 Stainless Steel | Rust Free | Weather Proof



PRODUCT INFORMATION

Part #	Light Holes	Switch Hole	Finish	Fitment
IC966020-14	2 - Watermelon	No	#8 304 Polished Stainless Steel	Peterbilt 359, 379 & 389
IC966021-14	2 - Watermelon	Yes	#8 304 Polished Stainless Steel	Peterbilt 359, 379 & 389
IC966023-14	8 - 3/4 in. Mini Button	Yes	#8 304 Polished Stainless Steel	Peterbilt 359, 379 & 389
IC966024-14	8 - 3/4 in. Mini Button	No	#8 304 Polished Stainless Steel	Peterbilt 359, 379 & 389
IC166022-14	1 - Watermelon	No	#8 304 Polished Stainless Steel	Peterbilt 389

BATTERY BOXES

Crafted and manufactured from the best 11GA 304 #8 Non-Directional Corrosion Resistant Stainless Steel, Iowa Customs' Battery Box is engineered to withstand years of use. Engineered with internal structure for added strength. Installation utilizes existing brackets on your truck! The Chrome Latch allows for ease of lid removal for access to vital components. Sold individually.

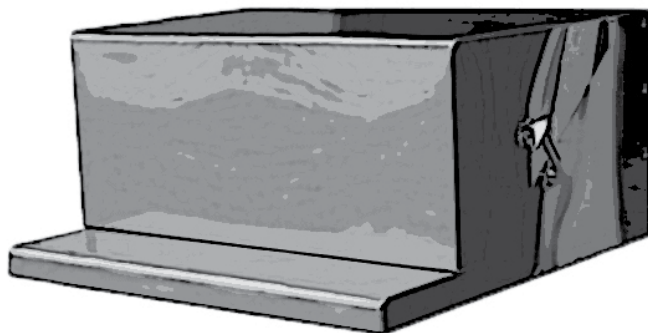

304 CORROSION RESISTANT
304 Stainless Steel | Rust Free | Weather Proof



PETERBILT
FITMENT
GUIDE



PRODUCT INFORMATION

Part #	Product	Dimensions	Finish	Fitment
IC173203-14	Battery Box	30 in. x 30 in. x 15 in.	#8 304 Polished Stainless Steel	Peterbilt 378, 379, 388, 389

SLIP COVERS

Iowa Customs Slip Covers offers a great looking solution without the cost of replacing the entire box. Engineered with internal structure withstand daily use and crafted from 14GA 304 #8 Non-Directional Corrosion Resistant Stainless Steel. Includes Heavy Duty Latches for easy removal.

- Sold in pairs

304 CORROSION RESISTANT
304 Stainless Steel | Rust Free | Weather Proof

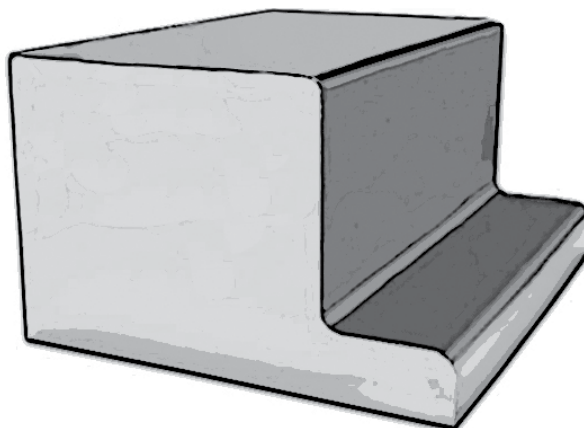

PRODUCT INFORMATION

Part #	Product	Dimensions	Finish	Fitment
IC173200-14	Slip Cover	33 in. x 28 in. x 20 in.	#8 304 Polished Stainless Steel	Peterbilt 378, 379, 388, 389

OEM TANK STRAP SKINS

Iowa Custom's Peterbilt OEM Tank Strap Skin offers a custom tank strap look by enhancing your existing OEM Tank Strap. Expertly crafted from 18GA #8 304 Stainless Steel, the Iowa Customs OEM Tank Strap Skin fits perfectly over your existing OEM Tank Strap, and installs utilizing high quality 3M adhesive tape. Engineered to precisely fit and rolled to the diameter of the Peterbilt OEM Tank Strap for ease of installation. No hardware is required.



PETERBILT
FITMENT
GUIDE



PRODUCT INFORMATION

Part #	Product	Size	Includes	Finish	Fitment
IC168020-14	OEM Tank Strap Skin	4 in.	(2) Skins, Pre-installed 3M Adhesive	#8 304 Polished Stainless Steel	See QR Code